

SUGGESTED
PAD
LAYOUT
Rounded
Pad

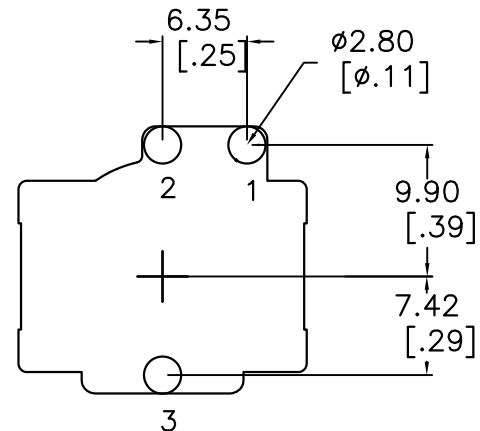

Schematic

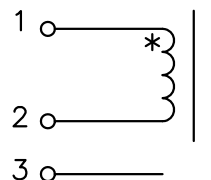

ELECTRICAL INFORMATION:

1. INDUCTANCE [1-2] = 220uH Nom, 200 Min. @100kHz/1V 2.35 Adc
2. DCR [1-2] = 58 mohms Nom, 68 Max
3. DIELECTRIC ISOLATION > 500 VDC [1-2] : CORE
4. SATURATION CURRENT @25C = 2.90 Adc | @85C = 2.75Adc
5. HEATING CURRENT FOR 40C RISE AT 25C AMBIENT = 5.0 Adc
6. Operating Ambient Temp. Range -40C to +85C
7. Non-Operating (Storage) Temp Range -55 to +130C
8. RoHS Level 6/6 Compliant

No.	DESCRIPTION	REVISIONS	DATE	APPR
THIRD ANGLE PROJECTION				
CHAMPS TECHNOLOGIES				
TOLERANCES +/- 1.0 UNLESS OTHERWISE INDICATED		SIGN	DATE	Champs No. PQA2050-220-LTC
DRAWN	HE	8/20/08	Customer	INDUCTOR
CHKD			Part #:	INDUCTOR
APPR			SIZE	SCALE 2:1
			ISSUE	REV
			A	00