

SUGGESTED PAD LAYOUT

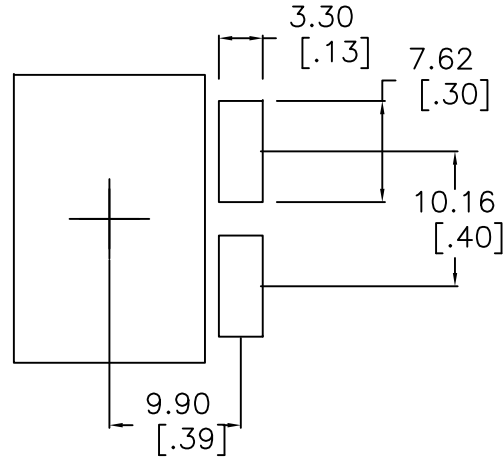

Schematic

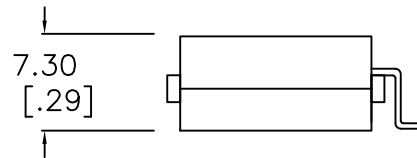
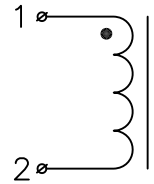

NOTES:

1. INDUCTANCE [1-2] = 0.65 uH ±15% @100kHz 1.0V @56 Adc
2. INDUCTANCE [1-2] = 0.50 uH ±15% @Isat 65 Adc
3. DCR [1-2] = 0.80 mohms Max
4. DIELECTRIC ISOLATION > 500 VDC [1-2] : CORE
5. SATURATION CURRENT @25C = 65 Adc | @100C = 58 Adc
6. HEATING CURRENT FOR 45C RISE AT 25C AMBIENT = 56 Adc
7. Operating Ambient Temperature: -40C to +100C
8. RoHS Level 6/6 Compliance || 96/4 Sn/Ag Pin Composition

No.		DESCRIPTION		REVISIONS	DATE	APPR
THIRD ANGLE PROJECTION						
CHAMPS TECHNOLOGIES						
TOLERANCES +/- 1.0 UNLESS OTHERWISE INDICATED		SIGN	DATE	Champs No. PQL2050-OR650-HX		
DRAWN	HE	08.05.14	Customer		ISSUE	REV
CHKD			Part #:		A	OO
APPR			SIZE	SCALE 2:1		