

SUGGESTED PAD LAYOUT

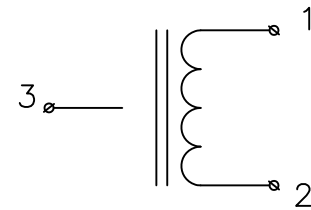
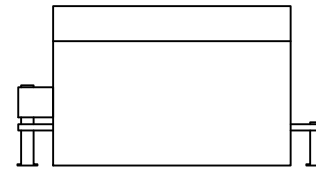
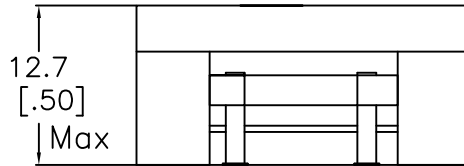
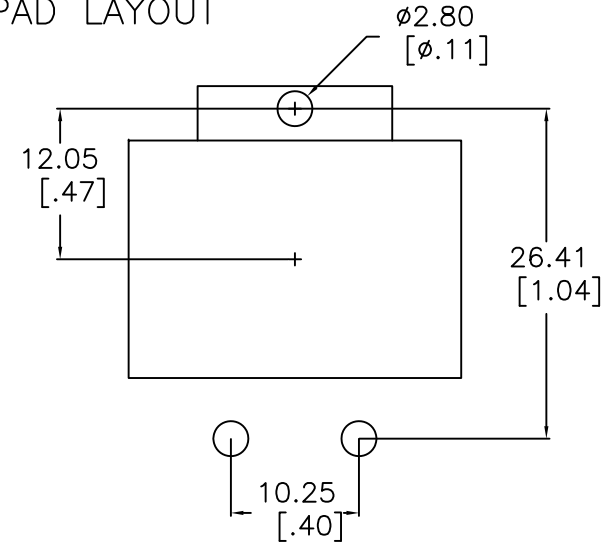

NOTES:

1. INDUCTANCE [1-2] = 330 uH Nom, ±10% @100kHz 1.0V 4.0 Adc
2. INDUCTANCE [1-2] = 280 uH Min @100kHz 1.0V 4.8 Adc @25C
3. DCR [1-2] = 69 mohms Nom, 81 Max
4. DIELECTRIC ISOLATION > 500 VDC [1-2], : CORE
5. SATURATION CURRENT @25C = 4.8 Adc | @100C = 4.0 Adc
6. HEATING CURRENT FOR 45C RISE AT 25C AMBIENT = 6 Adc
7. Operating Ambient Temperature: -55C to +130C [Inclusive of Temps Rise]
8. RoHS Level 6/6 Compliance || 96/4 Sn/Ag Pin Composition

No.	DESCRIPTION	REVISIONS	DATE	APPR
CHAMPS TECHNOLOGIES				
DRAWN		SIGN	DATE	Champs No. PQI26-330-LTC
CHKD				Customer   ISSUE
APPR			09.18.15	Part #:   A   REV
			SIZE	SCALE 2:1