

SUGGESTED THRU-HOLE LAYOUT

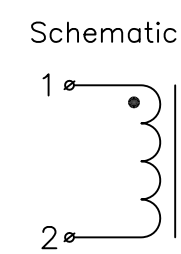
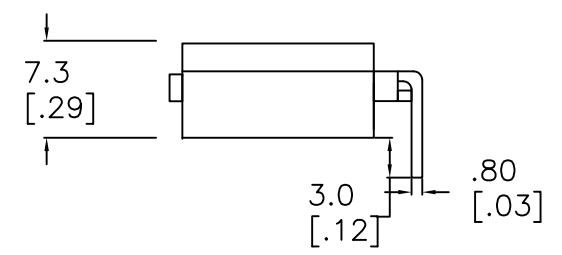
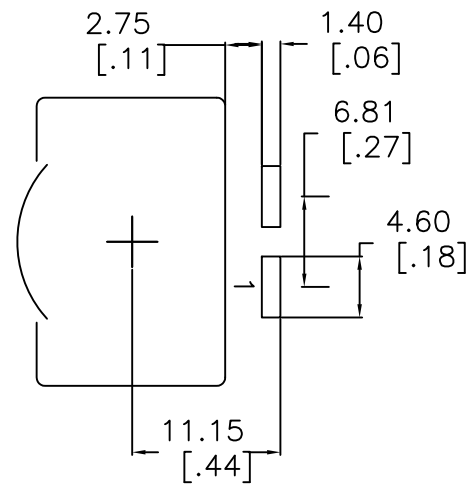

- NOTES:
1. INDUCTANCE [1-2] = 3.3 uH ±10% @100kHz 1.0V @ 0Adc
 2. INDUCTANCE [1-2] = Within Range ±10% Measured Value at 0Adc @Irated 22Adc
 3. DCR [1-2] = 2.2 mohms Nom.
 4. DIELECTRIC ISOLATION > 500 VDC [1-2] : CORE
 5. SATURATION CURRENT @25C = 26Adc | @100C = 24Adc
 6. HEATING CURRENT FOR 45C RISE AT 25C AMBIENT = 32 Adc
 7. Operating Ambient Temperature: -55C to +130C
 8. RoHS Level 6/6, REACH & CMRT Compliant || 96/4 Sn/Ag Pin Composition

| | | | | | | |
|---|-------|-------------|----------|----------------------------------|-----------|--------|
| No. | | DESCRIPTION | | REVISIONS | DATE | APPR |
| THIRD ANGLE PROJECTION | | | | | | |
| CHAMPS TECHNOLOGIES | | | | | | |
| TOLERANCES/UNITS in MM UNLESS OTHERWISE INDICATED | | SIGN | DATE | Champs-Tech PN PQL2050-3R3-22-TH | | |
| .XXX ± 0.254 | DRAWN | HE | 01.15.18 | Customer | | ISSUE |
| .XX ± 0.38 | CHKD | | | Part #: | | A |
| .X ± 0.78 | APPR | | | SIZE | SCALE 2:1 | REV 00 |
| ANGLE ± | | | | | | |