

- NOTES:
1. INDUCTANCE [1-5] = x.xx uH Nom, x.xx Min. @100kHz 1.0V 0Adc
 2. INDUCTANCE [1-5] = -15% Max Value at 0Adc @100kHz 1.0V xx Adc @25C
 3. DCR [1-5] = xx.x mohms Max
 4. DIELECTRIC ISOLATION > 500 VDC [1-5], : CORE
 5. SATURATION CURRENT @25C = xx Adc | @100C = xx Adc
 6. HEATING CURRENT FOR 45C RISE AT 25C AMBIENT = xx Adc
 7. Operating Ambient Temperature: -40C to +85C
 8. RoHS Level 6/6 Compliance || 96/4 Sn/Ag Pin Composition

PA1294 || PA1671 || PA1382 Series

No.	DESCRIPTION	REVISIONS	DATE	APPR
CHAMPS TECHNOLOGIES				
DRAWN		SIGN	DATE	Drwg.No.
CHKD		HE		TITLE: 1382 Series Inductor HM Style
APPR				ISSUE A
				REV 00
			SIZE	SCALE 2:1

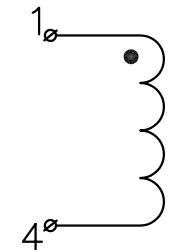
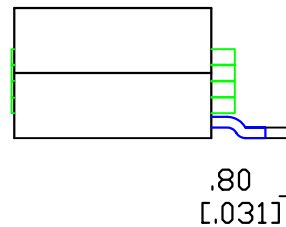
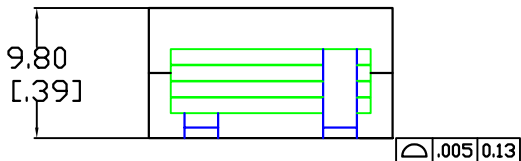
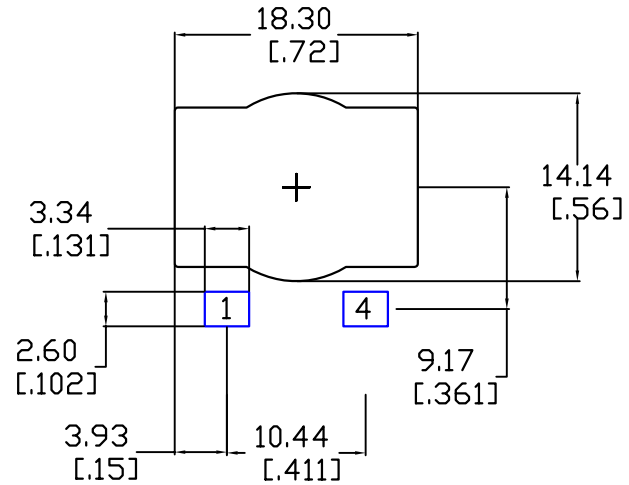
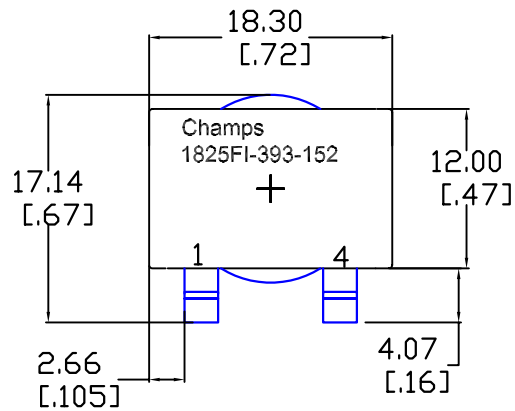

INDUCTANCE [1-4] = 1.4 uH Nom, 1.19 Min. @10kHz/0.1V 25Adc
 DCR [1-4] = 1.15 mohms Nom
 DIELECTRIC ISOLATION > 500 VDC [1-4] : CORE
 SATURATION CURRENT @25C = 30.0Adc
 HEATING CURRENT FOR 45C RISE AT 25C AMBIENT = 30 Adc

No.	DESCRIPTION		REVISIONS	DATE	APPR
THIRD ANGLE PROJECTION					
CHAMPS TECHNOLOGIES					
TOLERANCES UNLESS OTHERWISE INDICATED		SIGN	DATE	Drwg.No.	
.XXX ±		HE	11/6/08	TITLE: 1825FI-393-152	
.XX ±		CHKD		ISSUE	REV
.X ±		APPR		A	00
ANGLE ±				SIZE	SCALE 2:1

A
B
C
D
E
F

1 2 3 4 5 6 7 8

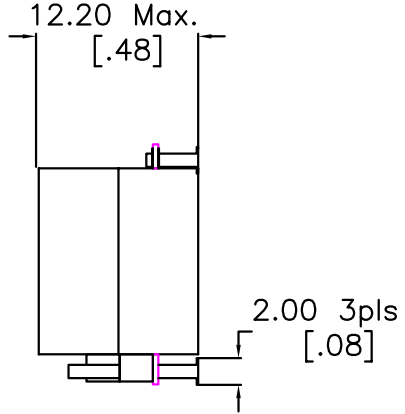
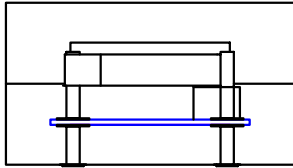
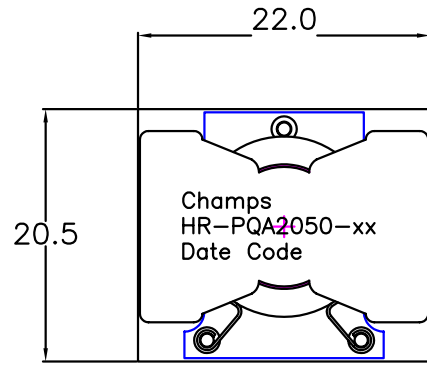
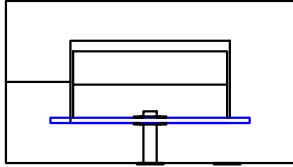

SUGGESTED
PAD
LAYOUT

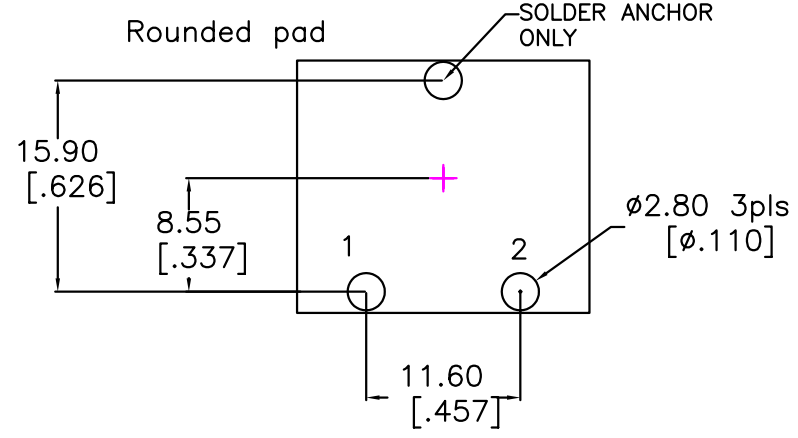
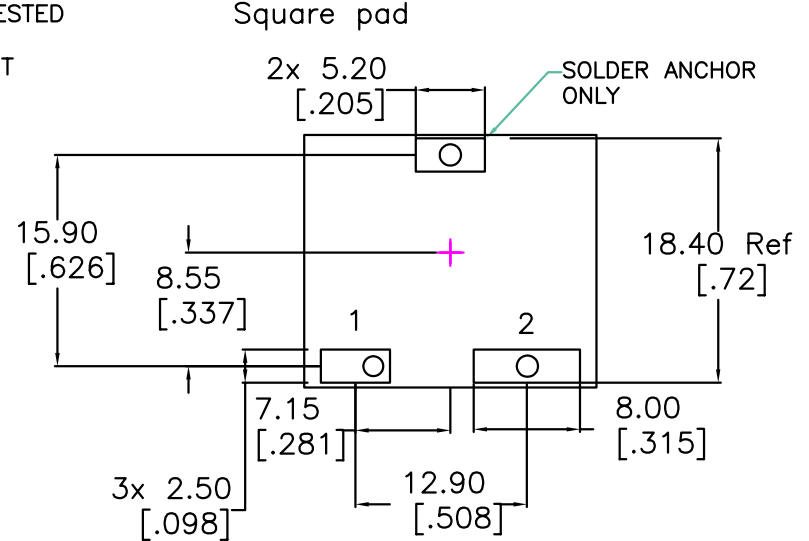

Schematic

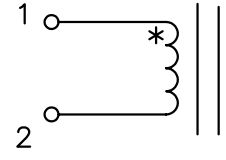

INDUCTANCE [1-2] = xx uH Nom, xx Min. @100kHz/1.0v xx Adc
 DCR [1-2] = xx mohms Nom, xx Max.
 DIELECTRIC ISOLATION > 500 VDC [1-2] : CORE
 SATURATION CURRENT @25C = xx Adc I @85C = xx Adc
 HEATING CURRENT FOR 40C RISE AT 25C AMBIENT = xx Adc

No.	DESCRIPTION		REVISIONS	DATE	APPR
THIRD ANGLE PROJECTION					
CHAMPS TECHNOLOGIES					
TOLERANCES UNLESS OTHERWISE INDICATED		SIGN	DATE	Drwg.No. HR-PQA2050-xx	
.XXX ±		HE		TITLE: INDUCTOR	
.XX ±		CHKD		ISSUE A	REV 00
.X ±		APPR		SIZE	SCALE 2:1
ANGLE ±					